

Weddings at The Mint



Photo © Corinna & Dylan



YOUR WEDDING

Congratulations on your engagement and thank you for considering The Mint for your special day.

Ceremony & Reception

Reception

Ceremony

Catering

Furniture, Decor & Audio Visual Upgrades

More Information

Your venue hire helps to keep our historic properties open for the future.

No matter the occasion, we invite you to celebrate your special moments across our heritage properties.

To help bring your upcoming wedding to life, we've created a range of packages just for you.



Photo © Corinna & Dylan

THE MINT

Ceremony & long banquet reception

Hold your ceremony in our historic Sandstone Courtyard and continue the celebrations with a long lunch or a lawn dinner under the stars – a unique dining experience.

VENUE HIRE	\$5000 inc GST*
TIME	10am–3pm 5pm–11pm [^]
CAPACITY	Seated: 110**
INCLUSIONS	Dedicated Venue Coordinator Event Supervisor (event) Wedding room Signing table & chairs 20 chairs (ceremony) 6 wooden bar tables Wooden easel 6 LED up lights Portable PA & microphone (speeches)
THE DETAILS	Set-up: 3 hours Ceremony: 1 hour Reception: 4 hours (lunch), 5 hours (dinner) Pack-down: 2 hours
HIRE ITEMS	Long banquet tables & chairs will need to be hired in for your lawn reception. You venue coordinator will be able to assist with recommended suppliers.

*Sunday & public holidays \$6000 inc GST. **In wet weather, we can comfortably accommodate up to 80 guests for your ceremony in the bar. [^] Outside daylight savings additional lighting such as festoon lighting is highly recommended.



THE MINT

Ceremony & Gold Melting Room reception

Hold your ceremony on our Raised Lawn following on with drinks and canapes in the Sandstone Courtyard, before your reception in our award-winning Gold Melting Room.

VENUE HIRE	\$4500 inc GST*
TIME	10am–3pm 5pm–11pm
CAPACITY	Seated: 100**
INCLUSIONS	Dedicated Venue Coordinator Event Supervisor (event) Wedding room Signing table & chairs 20 chairs (ceremony) 6 wooden bar tables 10 oval banquet tables 100 charcoal catifa chairs Wooden easel 6 LED up lights Internal PA & microphone (speeches)
THE DETAILS	Setup: 2 hours Ceremony: 1 hour Reception: 4 hours (lunch), 5 hours (dinner) Pack-down: 1 hour

*Sunday & public holidays \$5400 inc GST. **In wet weather, we can comfortably accommodate up to 80 guests for your ceremony in the bar.



THE MINT

Ceremony & Cocktail reception

Hold your ceremony in our historic Sandstone Courtyard, and experience the perfect combination of indoor and outdoor spaces for your cocktail reception.

VENUE HIRE	\$4500 inc GST*
TIME	10am–3pm 5pm–11pm
CAPACITY	Cocktail: 180
INCLUSIONS	Dedicated Venue Coordinator Event Supervisor (event) Wedding room Signing table & chairs 20 chairs 6 wooden bar tables Wooden easel 6 LED up lights Portable PA & microphone (speeches)
THE DETAILS	Set-up: 2 hours Ceremony: 1 hour Reception: 4 hours (lunch), 5 hours (dinner) Pack-down: 1 hour

*Sunday & public holidays \$5400 inc GST.





THE MINT

Long banquet

Enjoy a unique dining experience with a long banquet reception set within our historic Sandstone Courtyard; offering bespoke styling in a picturesque setting.

VENUE HIRE	\$4500 inc GST*
TIME	11am–3pm 6.30pm–11.30pm^
CAPACITY	Seated: 110
INCLUSIONS	Dedicated Venue Coordinator Event Supervisor (event) Wedding room 6 wooden bar tables 10 scatter chairs Wooden easel 6 LED up lights Internal PA & microphone (speeches)
THE DETAILS	Set-up: 3 hours Reception: 4 hours (lunch), 5 hours (dinner) Pack-down: 2 hours
HIRE ITEMS	Long banquet tables & chairs will need to be hired in for your lawn reception. You venue coordinator will be able to assist with recommended suppliers.

Museums of History NSW cares for a group of 12 of the most important historic houses, gardens and museums in NSW on behalf of all Australians.



THE MINT

Gold Melting Room reception

Experience the perfect combination of indoor and outdoor spaces in our Gold Melting Room, with wooden louvers and glass panels which raise and open onto the Sandstone Courtyard.

VENUE HIRE	\$4000 inc GST*
TIME	11am–3pm 6.30pm–11.30pm
CAPACITY	Seated: 100
INCLUSIONS	Dedicated Venue Coordinator Event Supervisor (event) Wedding room 6 wooden bar tables 10 scatter chairs 10 oval banquet tables 100 charcoal catifa chairs Wooden easel 6 LED up lights Portable PA & microphone (speeches)
THE DETAILS	Set-up: 2 hours Reception: 4 hours (lunch), 5 hours (dinner) Pack-down: 1 hour



THE MINT

Cocktail reception

Host your cocktail reception in our historic Sandstone Courtyard with Raised Lawn and stylish glass Bar – the perfect place to dance the night away.

VENUE HIRE	\$4000 inc GST*
TIME	11am–3pm 6.30pm–11.30pm
CAPACITY	Cocktail: 200
INCLUSIONS	Dedicated Venue Coordinator Event Supervisor (event) Wedding room 20 wooden chairs 6 wooden bar tables Wooden easel 6 LED up lights Portable PA & microphone (speeches)
THE DETAILS	Setup: 2 hours Reception: 4 hours (lunch), 5 hours (dinner) Pack-down: 1 hour

*Sunday & public holidays \$4800 inc GST.

Our purpose is to enrich and revitalise people's lives with Sydney's living history, and to hand the precious places in our care and their collections on to future generations to enjoy.



THE MINT

Ceremony

Host your ceremony within our historic Sandstone Courtyard, including our gorgeous Raised Lawn area with Crepe Myrtle tree – the perfect backdrop for your wedding.

VENUE HIRE	\$2900 inc GST*
TIME	Morning: 9am–11am Afternoon: 12pm–2pm
CAPACITY	Ceremony: 180
INCLUSIONS	Dedicated Venue Coordinator Event Supervisor (event) Wedding room Signing table & chairs 20 chairs (ceremony) 3 wooden bar tables Wooden easel
THE DETAILS	Set-up: 1 hour Ceremony: 2 hours Pack-down: 30 minutes
OPTIONAL	Treat your guests to an hour of drinks & canapes or a styled grazing station post-ceremony by our onsite hospitality partner Pearl Catering.



THE MINT

Catering

Our onsite hospitality partner is Pearl Catering. Pearl's team of restaurant and catering professionals bring a true commitment to event management, creativity and innovation using only the finest and sustainable ingredients sourced from Sydney's top providores.

THE DETAILS

Please refer to the separate catering kit provided as a guide for your food and beverage options. The team can also tailor a quote to suit your needs, offering bespoke wedding packages for both your ceremony and reception.

CONTACT

Please email weddings@pearlcatering.com.au for a tailored quote

EXCLUSIVITY

Please note as a heritage site we work on an exclusive basis with Pearl Catering. The team can work with you on a menu option to suit your needs, including dietary requirements and menu tastings are available upon request.

Have a special idea in mind? Pearl Catering can also source a range of options to bring your event to life including gelato bars, spritz stations, rum or gin tasting, and more.

Please refer to the Important Information section for additional details in relation to food and beverages at The Mint



THE MINT

Furniture, Décor and Audio Visual Upgrades

Please find below a list of additional furniture, linen and audio-visual hire items available for your event.

Furniture

Bentwood chairs (10 to 60) + *\$250 delivery fee	\$12 each*
Bentwood chairs (60 to 110) + *\$450 delivery fee	\$12 each*
White clothed round signing table	\$80
Gold Melting Room linen drape (back wall)	\$250
Linen oatmeal banquet tablecloths (up to 10)	from \$66 each
Linen oatmeal Bridal long table cloth	from \$100 each

Audio Visual

Portable PA System	\$250
Additional 6 LED up lights from	\$210
Courtyard extension speakers	\$450
AV technician	\$560

All prices are inclusive of GST.



IMPORTANT INFORMATION

EVENTS

A booking is not considered confirmed until a signed contract and 50% deposit has been received by your Venue Coordinator within 14 days (your balance will be due one month prior). For bookings less than 90 days out, the full venue hire is payable. Other areas of the site do not form part of your venue hire, unless outlined on your contract.

WET WEATHER

In the case of wet weather, you can host your ceremony in the contemporary glass bar, before guests move into the Gold Melting Room for your reception. For a ceremony only, this can be hosted in the Gold Melting Room.

EXCLUSIVITY

We offer weddings on an exclusive use arrangement on weekends, outside of any private bookings in our onsite restaurant. Please note the property is open to the public Monday to Friday until 5pm and operates as Museums of History NSW head office; in which instance the venue is partially exclusive on weekdays and private event signage is in place to redirect patrons away from your event.

SET-UP & PACK-DOWN TIME

Please note that your contracted 'bump-in' and 'bump-out' times, also referenced as set-up and pack-down times, are non-exclusive and may overlap with another booking before or after yours. Additional access time can be made available upon request at an hourly rate pending availability.

TIME

Additional access time can be made available upon request at an hourly rate in some circumstances.

FURNITURE & STYLING

The Mint is a beautiful space with a stunning mix of heritage and contemporary features. However, should you require additional styling – including florals, furniture and décor – our team can recommend reputable suppliers who have worked in our venue before. Please do not hesitate to discuss this with your Wedding Venue Coordinator.

PHOTOS

All photography is available in internal and external areas of the site as guided by your Event Supervisor on the day.

CAKES

Cakes via an external supplier are permitted, and can be discussed directly with Pearl Catering for delivery and service. Please note we do not permit any bright coloured icing, chocolate mud, or berry cakes that could stain the heritage sandstone. The venue can provide a cake table & knife on the day of your booking.

MUSICIANS

There are no noise restrictions on site in the evening, and musicians are permitted. We can provide armless chairs for your musicians. Feel free to ask our team for recommendations.

PARKING

The Mint has parking onsite for two bridal vehicles (seven days a week) and up to three additional spaces for your suppliers such as a band, photographer and stylist (weekends & after 5pm only). There is on-street parking on Hospital Road, or at the Domain carpark, which has a flat rate after 5pm and on weekends. High powered vehicles and motorbikes are not permitted on site.

CLOAKING

Cloaking services can be made available on request, and quoted accordingly.

CONDITIONS

Rose petals, rice, glitter and the like are not permitted. We recommend bubbles as an alternative. There is no smoking on our sites, this includes vaping. Smoke machines are not permitted on site. We operate under the guidelines of the Independent Liquor and Gaming authority and are bound by their regulations. There is no BYO alcohol on our sites. We do not permit the use of drones on our sites. Wax candles and open flames are not permitted unless for a religious ceremony. You cannot attach or fix to any buildings, trees, or the like on our sites. Damage or breakage to the property will result in fines and additional fees.

SITE PLAN

Ground floor

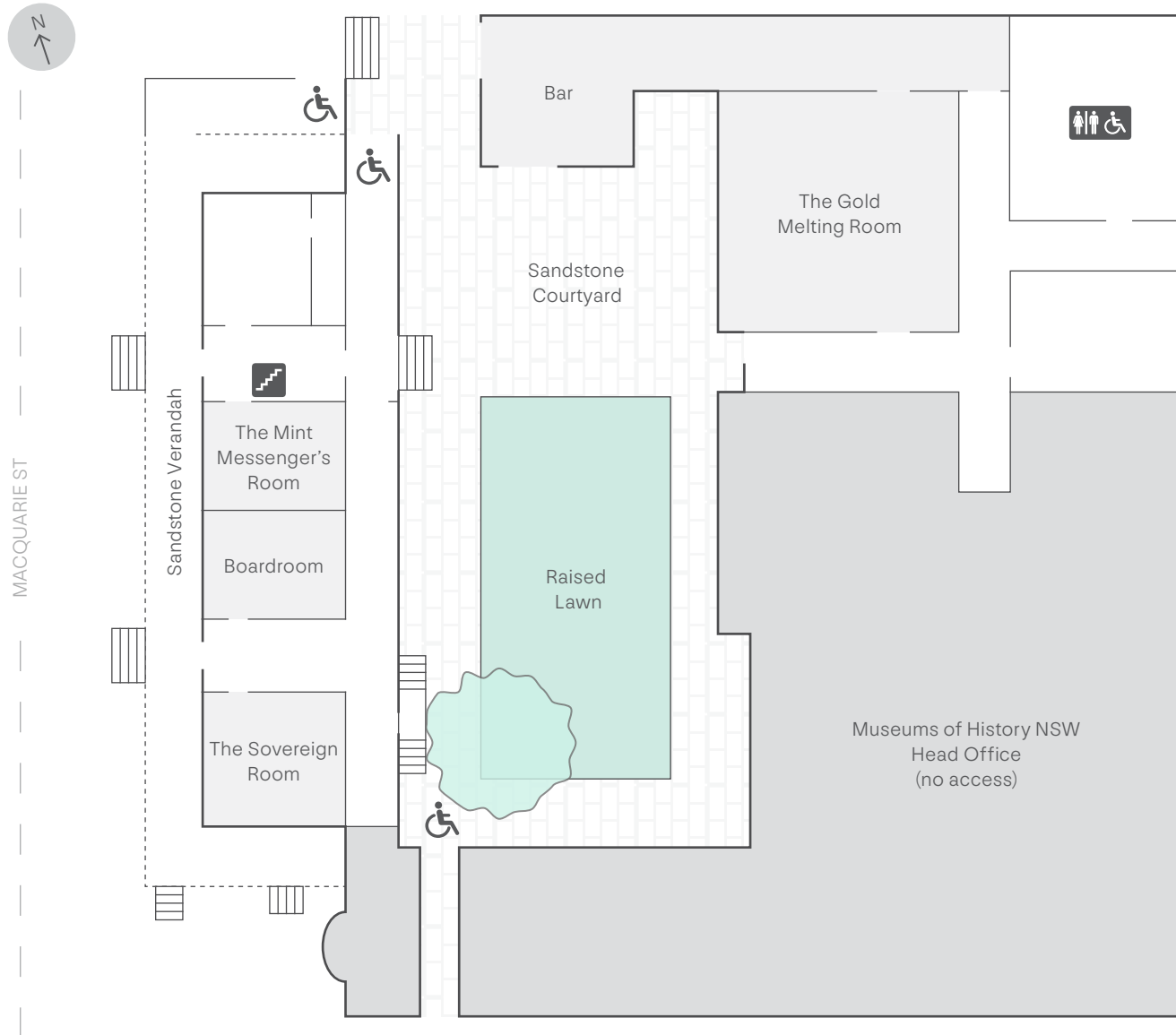

First floor

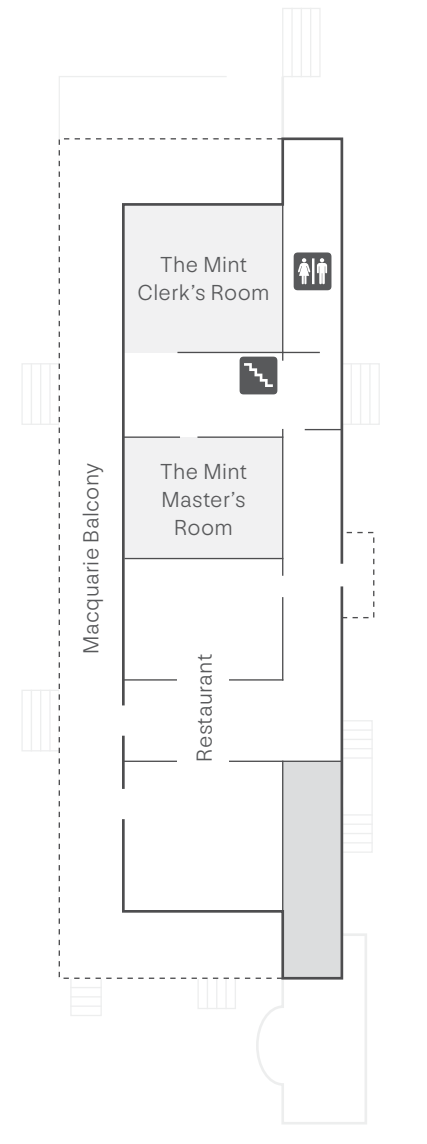

Thank you for considering our properties. Your venue hire helps to keep our historic properties open for the future.

Our dedicated Venue Services team can assist with any additional questions or information you may require.

To book or request a site visit please contact our team on:

02 8239 2333
venues@mhnsw.au

 @mhnswvenues

Photo © Corinna & Dylan

MINT_WED_1122

